

Making Circuits Work

Electricity flows through a circuit. A very simple circuit has a battery that supplies the electricity. The electricity flows around the circuit through wires to make things work.

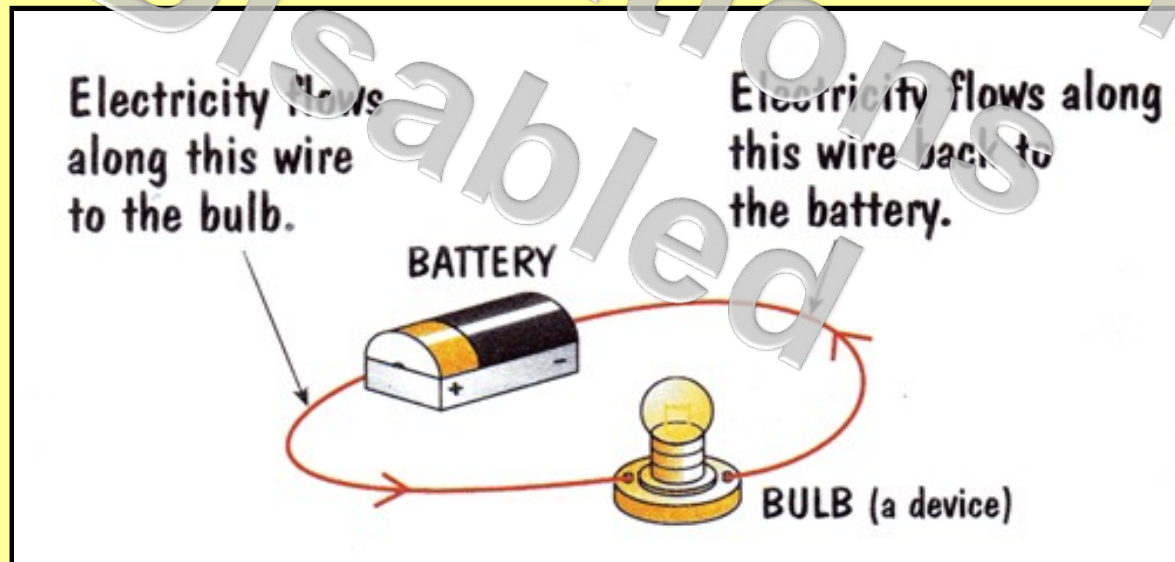

Electricity will not flow through a circuit that has a 'break' or gap in it. A switch is a device which can break a circuit. This is very useful as it saves electricity.

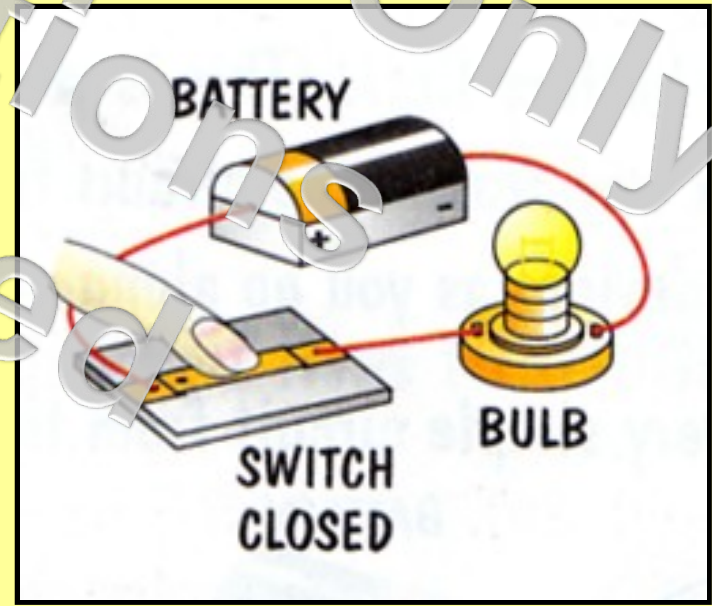
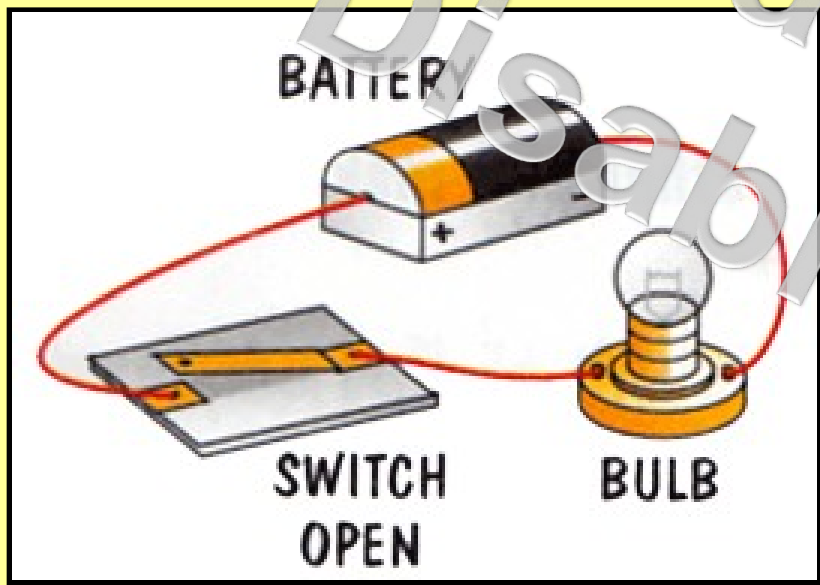

Will the Circuit Work?

Click on each circuit to find out if it will work.

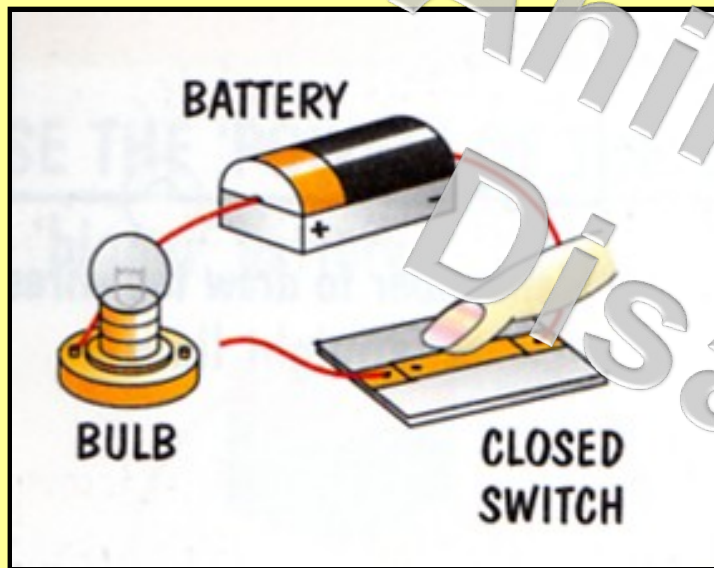

The wire from the switch is not connected to the bulb. The circuit has a break in it and the bulb is off.

Solution: Connect the Wire to the Bulb

Will the Circuit Work?

Click on each circuit to find out if it will work.

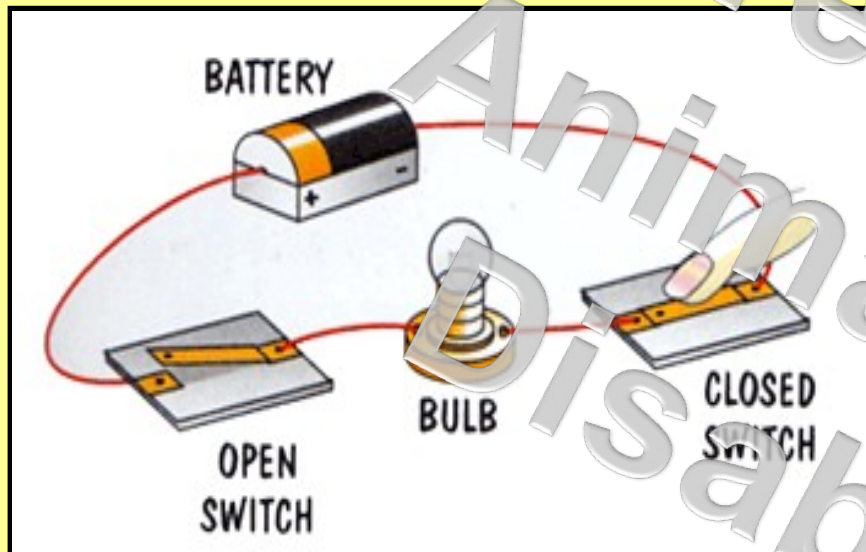

This circuit has two switches in it. One switch is closed but the other is wide open. The bulb is off.

Solution: Close the open switch.

Will the Circuit Work?

Click on each circuit to find out if it will work.

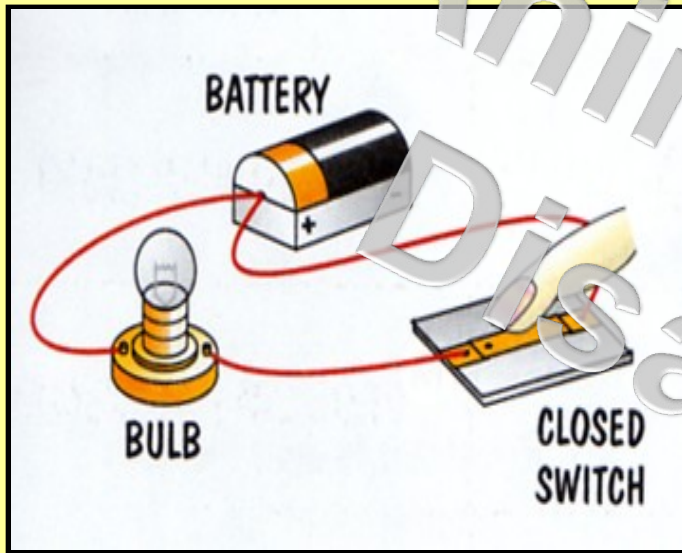

Both wires are connected to one end of the battery, the positive end.

Solution: Connect one of the wires to the other end of the battery.

Will the Circuit Work?

Click on each circuit to find out if it will work.

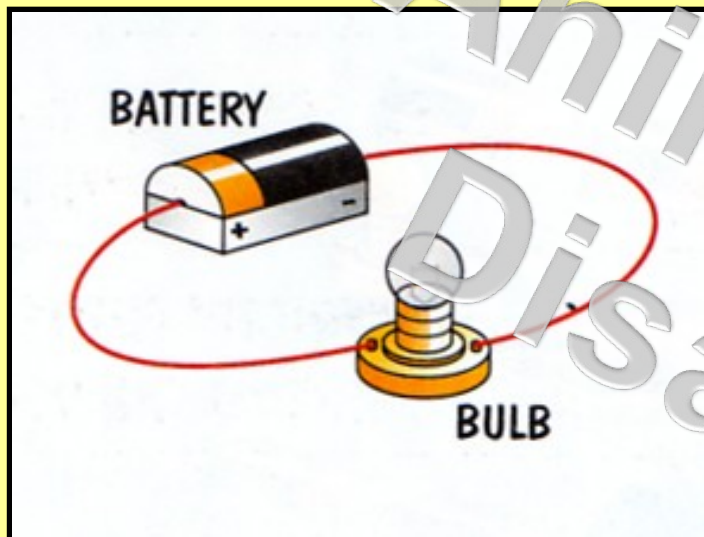

The circuit is connected properly. In this case, the battery is flat, or the bulb has blown.

Solution: Change the battery or the bulb.